

# DRUTEX S.A.

## MB-79N SI BALCONY DOOR (HVHZ)(IMPACT)

### GENERAL NOTES:

- THE PRODUCT SHOWN HEREIN IS DESIGNED AND MANUFACTURED TO COMPLY WITH THE CURRENT EDITION FLORIDA BUILDING CODE (FBC), INCLUDING HVHZ AND HAS BEEN EVALUATED ACCORDING TO THE FOLLOWING:
  - AAMA/WDMA/CSA 101/I.S.2/A440-17
  - ASTM E1886-19
  - ASTM E1996-20
  - TAS 201-94
  - TAS 202-94
  - TAS 203-94
- ADEQUACY OF THE EXISTING STRUCTURAL CONCRETE/MASONRY, 2X FRAMING, AND METAL FRAMING AS A MAIN WIND FORCE RESISTING SYSTEM CAPABLE OF WITHSTANDING AND TRANSFERRING APPLIED PRODUCT LOADS TO THE FOUNDATION IS THE RESPONSIBILITY OF THE ENGINEER OR ARCHITECT OF RECORD FOR THE PROJECT OF INSTALLATION.
- 1X AND 2X BUCKS (WHEN USED) SHALL BE DESIGNED AND ANCHORED TO PROPERLY TRANSFER ALL LOADS TO THE STRUCTURE. BUCK DESIGN AND INSTALLATION IS THE RESPONSIBILITY OF THE ENGINEER OR ARCHITECT OF RECORD FOR THE PROJECT OF INSTALLATION.
- INSTALL INDIVIDUAL INSTALLATION ANCHORS WITHIN A TOLERANCE OF  $\pm 1/4$  INCH OF THE DEPICTED LOCATION IN THE ANCHOR LAYOUT DETAIL (I.E., WITHOUT CONSIDERATION OF TOLERANCES). TOLERANCES ARE NOT CUMULATIVE FROM ONE INSTALLATION ANCHOR TO THE NEXT.
- THE INSTALLATION DETAILS DESCRIBED HEREIN ARE GENERIC AND MAY NOT REFLECT ACTUAL CONDITIONS FOR A SPECIFIC SITE. IF SITE CONDITIONS CAUSE INSTALLATION TO DEVIATE FROM THE REQUIREMENTS DETAILED HEREIN, A LICENSED ENGINEER OR ARCHITECT SHALL PREPARE SITE SPECIFIC DOCUMENTS FOR USE WITH THIS DOCUMENT.
- APPROVED IMPACT PROTECTIVE SYSTEM **IS NOT REQUIRED** ON THIS PRODUCT IN AREAS REQUIRING IMPACT RESISTANCE.
- DOOR FRAME MATERIAL: ALUMINUM 6063-T5
- GLASS MEETS THE REQUIREMENTS OF ASTM E 1300 GLASS CHARTS. SEE SHEET 1 FOR GLAZING DETAIL.
- CUSTOM SIZES AVAILABLE UPON REQUEST. CUSTOM DESIGN PRESSURE WILL BE ASSIGNED EQUAL TO NEXT LARGER STANDARD SIZE.

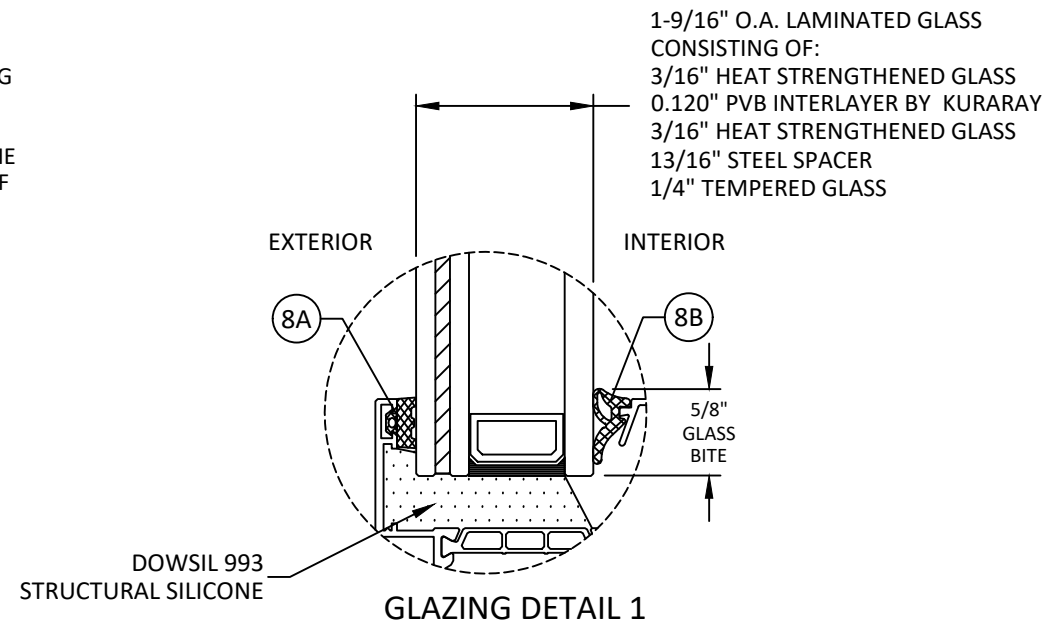

### GLAZING NOTES:

- GLASS TYPE COMPLIES WITH ASTM E1300 REQUIREMENTS. PER THE FBC TEMPER AND SAFETY GLAZING REQUIREMENTS SHALL BE REVIEWED ON A SITE SPECIFIC BASIS.
- SETTING BLOCK DUROMETER HARDNESS OF 70-90 (SHORE A) AS REFERENCED IN FBC CHAPTER 24.
- SETTING BLOCKS TO BE LOCATED AT 1/4 SPAN LENGTH FOR GLASS WIDER THAN 36" AS PER FBC CHAPTER 24.
- D.L.O. AND DESIGN PRESSURES MAY NOT EXCEED MAX VALUES SHOWN HEREIN.

TABLE OF CONTENTS	
SHEET	SHEET DESCRIPTION
1	GENERAL NOTES & GLAZING DETAIL
2	ELEVATIONS & DESIGN PRESSURE TABLES
3	ANCHOR LAYOUTS
4	VERTICAL SECTIONS
5	HORIZONTAL SECTIONS
6	INSTALLATION NOTES & ANCHOR DETAILS
7	COMPONENTS & BILL OF MATERIALS

CONFIGURATION	WIDTH (IN.)	HEIGHT (IN.)	DESIGN PRESSURE	MISSILE IMPACT RATING
X	SEE TABLES ON SHEETS 2 - 3			LARGE AND SMALL MISSILE IMPACT



LEBORSKA 31, 77-100  
BYTOW, POLAND  
PH: +48-59-822-9101 FX: +48-59-822-9103

TITLE: MB-79N SI  
BALCONY DOOR WINDOW  
(HVHZ) (IMPACT)

GENERAL NOTES &  
GLAZING DETAILS

PREPARED BY:  
BUILDING DROPS, INC.

1900 NE MIAMI COURT, STE. 2-15  
MIAMI, FL 33132  
PH: (954) 399-8478  
FAX: (954) 744-4738  
WEB: www.buildingdrops.com



REMARKS	BY	DATE

THE INSTALLATION DETAILS DESCRIBED HEREIN ARE GENERIC AND MAY NOT REFLECT ACTUAL CONDITIONS FOR A SPECIFIC SITE. IF SITE CONDITIONS CAUSE INSTALLATION TO DEVIATE FROM THE REQUIREMENTS DETAILED HEREIN, A LICENSED ENGINEER OR ARCHITECT SHALL PREPARE SITE SPECIFIC DOCUMENTS FOR USE WITH THIS DOCUMENT.



FL #:

**FL46724**

DATE: **03.19.24**

DWG. BY:  
**FB**

CHK. BY:  
**HFN**

SCALE: **NTS**

DWG. #: **DRU039**

SHEET:

**1**

OF 7

5/1/2024 3:09 PM  
 c:\users\franciscobreno\building\_drops, inc\building\_drops\_landing - common\projects\drutex, s.a\bc-23-0705.1 - bc\_submittal - mb79n.si\mb86n.si\aluminum\_systems\dwgs\mb79n\mb79n - balcony\_door\archive\dru039.dwg

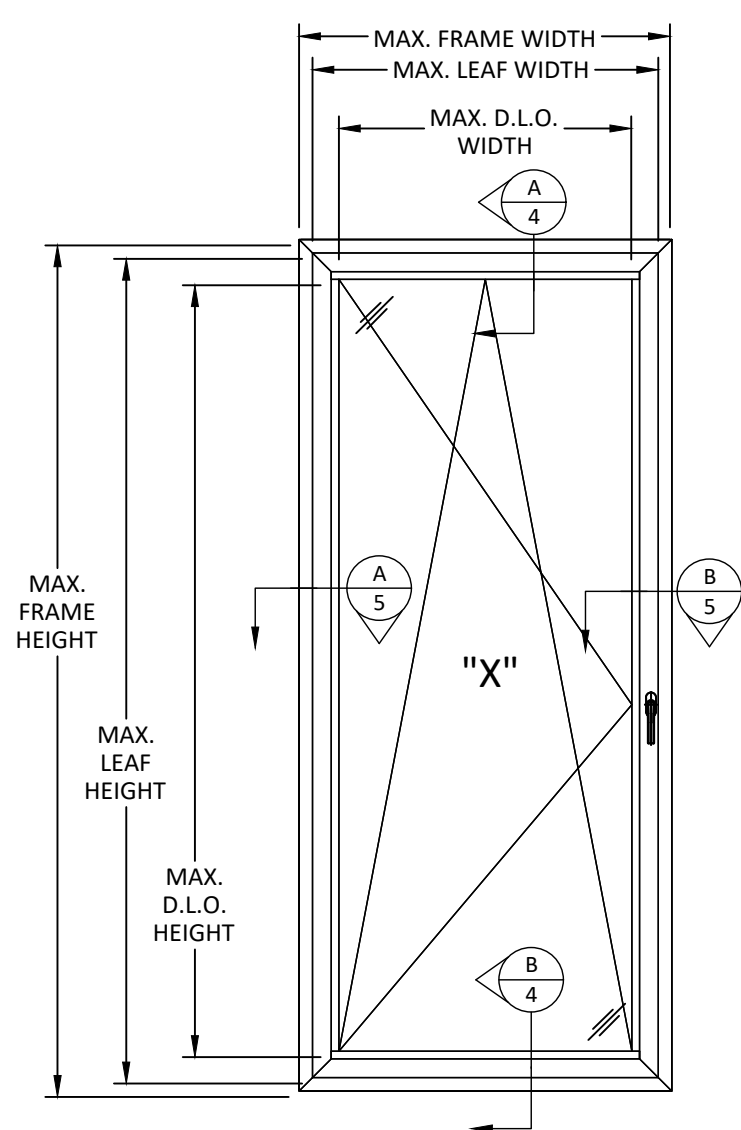

**ELEVATIONS**

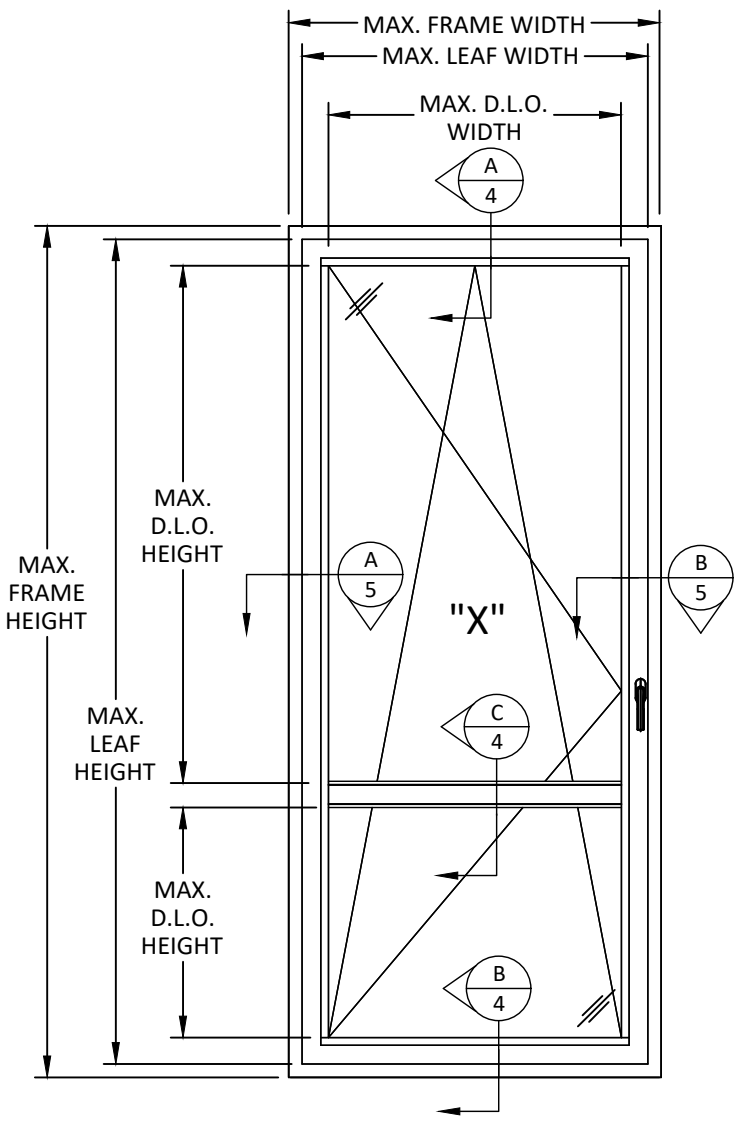

**ELEVATIONS**

LEAF HEIGHT = FRAME HEIGHT - 5.50"  
 LEAF WIDTH = FRAME WIDTH - 5.50"  
 D.L.O. HEIGHT = FRAME HEIGHT - 3.50"  
 D.L.O. WIDTH = FRAME WIDTH - 3.50"

**MID-RAIL GLASS SIZES DESIGN PRESSURE TABLE**

DESIGN PRESSURE TABLE (PSF)		
NOMINAL DIMS.		POS.(+) NEG.(-)
D.L.O. HEIGHT (IN.)	D.L.O. WIDTH (IN.)	
56	24	70.0
56	30	70.0
56	36	70.0
58	42	70.0
52	48	70.0
48	54	70.0
42	60	70.0
42	66	70.0
38	72	70.0

**FRAME DESIGN PRESSURE TABLES**

DESIGN PRESSURE TABLE (PSF)		
NOMINAL DIMS.		POS.(+) NEG.(-)
FRAME WIDTH (IN.)	FRAME HEIGHT (IN.)	
24	72	70
30		70
36		70
41		70
48		60
54	53	
24	78	70
30		70
36		70
41		70
48		60
24	84	70
30		70
36		70
41		70
48		60
24	90	70
30		70
36		70
41		70
48		60
24	96	70
30		70
36		70
41		70
48		60



LEBORSKA 31, 77-100  
 BYTOW, POLAND  
 PH: +48-59-822-9101 FX: +48-59-822-9103

TITLE: MB-79N SI  
 BALCONY DOOR WINDOW  
 (HVHZ) (IMPACT)

ELEVATIONS &  
 DESIGN PRESSURE TABLES

PREPARED BY:  
 BUILDING DROPS, INC.  
 1900 NE MIAMI COURT, STE. 2-15  
 MIAMI, FL 33132  
 PH: (954)399-8478  
 FAX: (954)744-4738  
 WEB: www.buildingdrops.com



REMARKS	BY	DATE

THE INSTALLATION DETAILS DESCRIBED HEREIN ARE GENERIC AND MAY NOT REFLECT ACTUAL CONDITIONS FOR A SPECIFIC SITE. IF SITE CONDITIONS CAUSE INSTALLATION TO DEVIATE FROM THE REQUIREMENTS DETAILED HEREIN, A LICENSED ENGINEER OR ARCHITECT SHALL PREPARE SITE SPECIFIC DOCUMENTS FOR USE WITH THIS DOCUMENT.

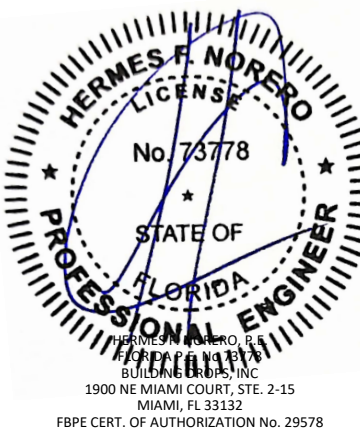

FL #:

**FL46724**

DATE: **03.19.24**

DWG. BY: **FB**

CHK. BY: **HFN**

SCALE: **NTS**

DWG. #: **DRU039**

SHEET:

**2**

OF 7

c:\Users\franciscobreno\building\_drops, inc\building\_drops\_landing - common\projects\drutex, s.a\fb-23-0705.1 - fb- submittal - mb79n.si mb86n.si aluminum\_systems\dwg\mb79n\mb79n - balcony\_door\archive\dr039.dwg 5/1/2024 3:09 PM

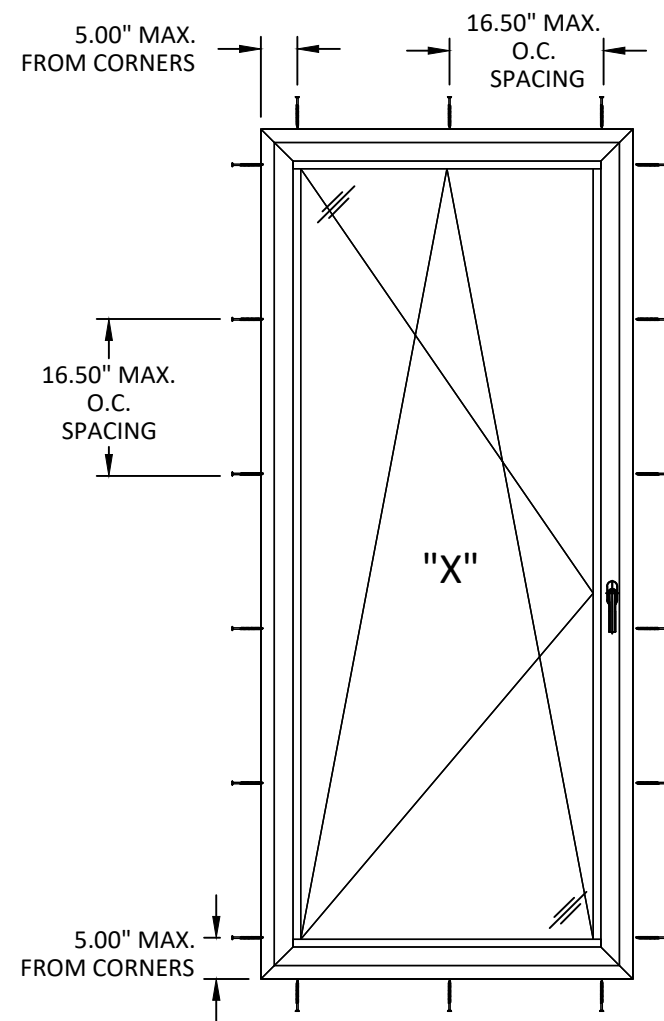

**ANCHOR LAYOUT  
THROUGH FRAME INSTALLATION**

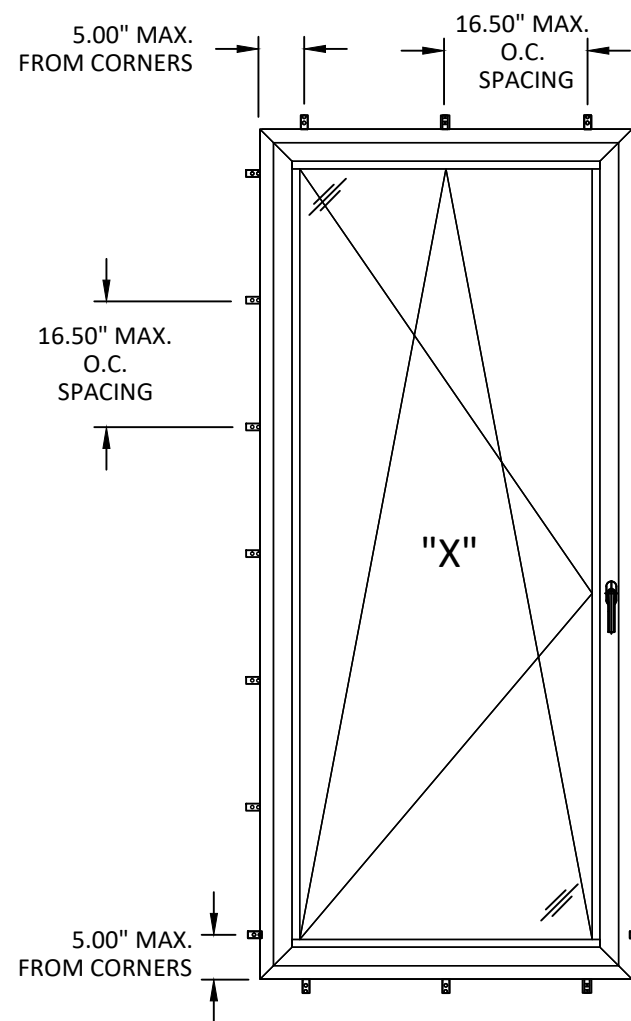

**ANCHOR LAYOUT  
STRAP INSTALLATION**

NOTE: TWO (2) ANCHORS PER STRAP.



LEBORSKA 31, 77-100  
BYTOW, POLAND  
PH: +48-59-822-9101 FX: +48-59-822-9103

TITLE: MB-79N SI  
BALCONY DOOR WINDOW  
(HVHZ) (IMPACT)

ANCHOR LAYOUTS

PREPARED BY:  
**BUILDING DROPS, INC.**  
1900 NE MIAMI COURT, STE. 2-15  
MIAMI, FL 33132  
PH: (954) 399-8478  
FAX: (954) 744-4738  
WEB: www.buildingdrops.com



REMARKS	BY	DATE

THE INSTALLATION DETAILS DESCRIBED HEREIN ARE GENERIC AND MAY NOT REFLECT ACTUAL CONDITIONS FOR A SPECIFIC SITE. IF SITE CONDITIONS CAUSE INSTALLATION TO DEVIATE FROM THE REQUIREMENTS DETAILED HEREIN, A LICENSED ENGINEER OR ARCHITECT SHALL PREPARE SITE SPECIFIC DOCUMENTS FOR USE WITH THIS DOCUMENT.

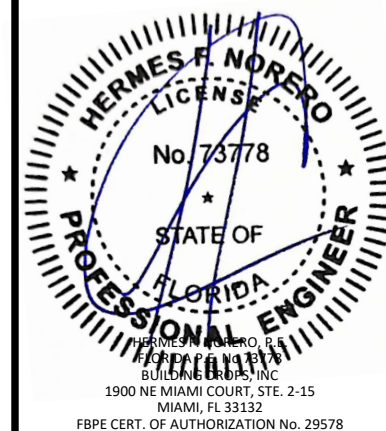

FL #: **FL46724**

DATE: **03.19.24**

DWG. BY: **FB**      CHK. BY: **HFN**

SCALE: **NTS**

DWG. #: **DRU039**

SHEET:  
**3**  
OF 7

c:\users\franciscobreno\building\_drops, inc\building\_drops\_landing - common\projects\drutex, s.a\fb-23-0705.1 - fb\_submittal - mb79n.si.mbb8n.si.aluminum\_systems\dwgs\mb79n.mb79n - balcony\_door\archive\dru039.dwg 5/1/2024 3:10 PM

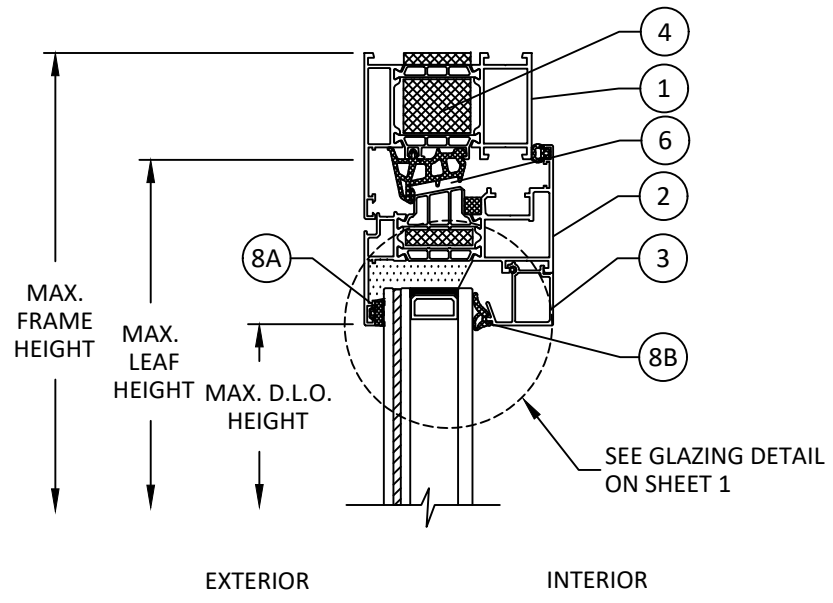

**A**  
**4** VERTICAL SECTION  
TYP. HEAD DETAIL

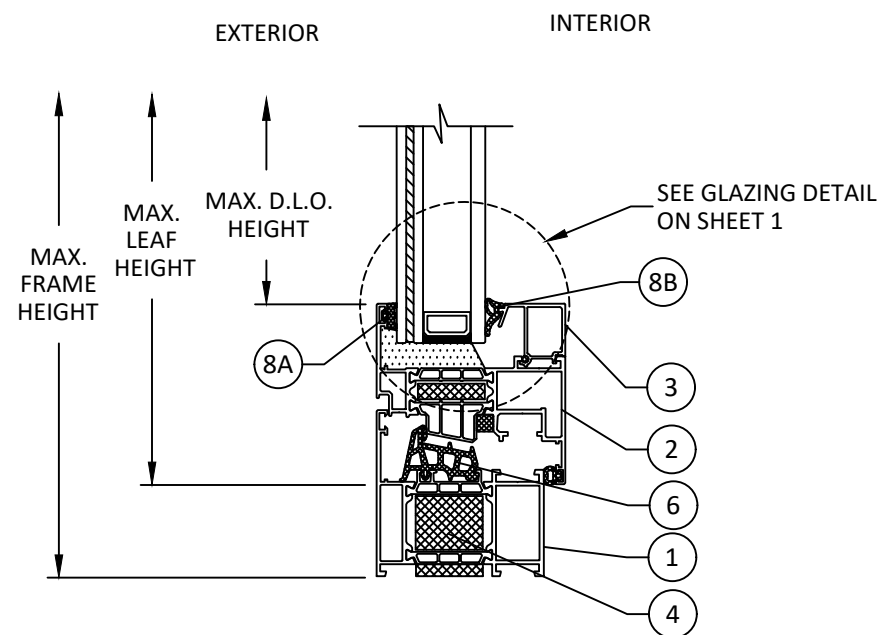

**B**  
**4** VERTICAL SECTION  
TYP. SILL DETAIL

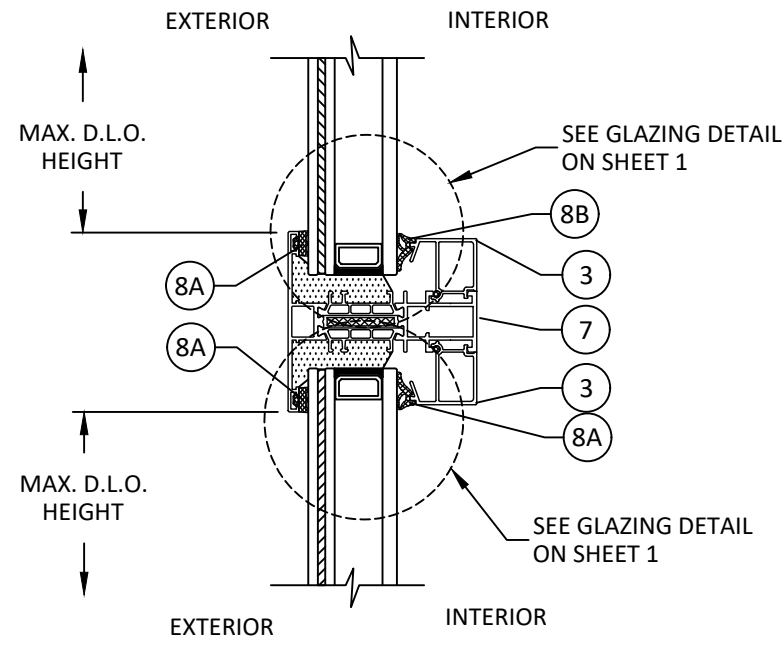

**C**  
**4** VERTICAL SECTION  
TYP. MID-RAIL DETAIL



LEBORSKA 31, 77-100  
BYTOW, POLAND  
PH: +48-59-822-9101 FX: +48-59-822-9103

TITLE: MB-79N SI  
BALCONY DOOR WINDOW  
(HVHZ) (IMPACT)

VERTICAL SECTIONS

PREPARED BY:  
**BUILDING DROPS, INC.**  
1900 NE MIAMI COURT, STE. 2-15  
MIAMI, FL 33132  
PH: (954) 359-8478  
FAX: (954) 744-4738  
WEB: www.buildingdrops.com



REMARKS	BY	DATE

THE INSTALLATION DETAILS DESCRIBED HEREIN ARE GENERIC AND MAY NOT REFLECT ACTUAL CONDITIONS FOR A SPECIFIC SITE. IF SITE CONDITIONS CAUSE INSTALLATION TO DEVIATE FROM THE REQUIREMENTS DETAILED HEREIN, A LICENSED ENGINEER OR ARCHITECT SHALL PREPARE SITE SPECIFIC DOCUMENTS FOR USE WITH THIS DOCUMENT.

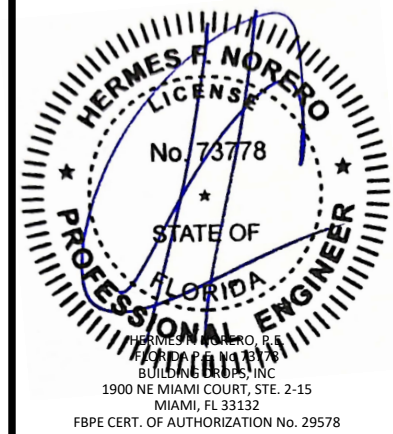

FL #: **FL46724**

DATE: **03.19.24**

DWG. BY: **FB**      CHK. BY: **HFN**

SCALE: **NTS**

DWG. #: **DRU039**

SHEET:  
**4**  
OF 7

c:\users\franciscobreno\building\_drops, inc\building\_drops\_landing - common\projects\drutex, s.a\fb-23-0705.1 - fb-submittal - mb79n-si-mb86n-si-aluminum\_systems\dwg\mb79n\mb79n - balcony\_door\archive\dru039.dwg 5/1/2024 3:10 PM

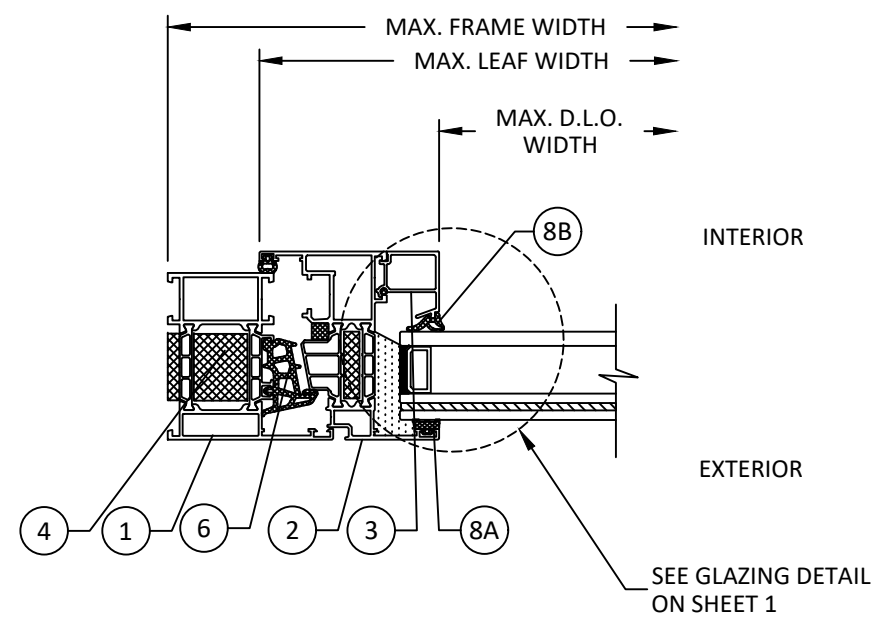

**A**  
5  
HORIZONTAL SECTION  
TYP. JAMB DETAIL

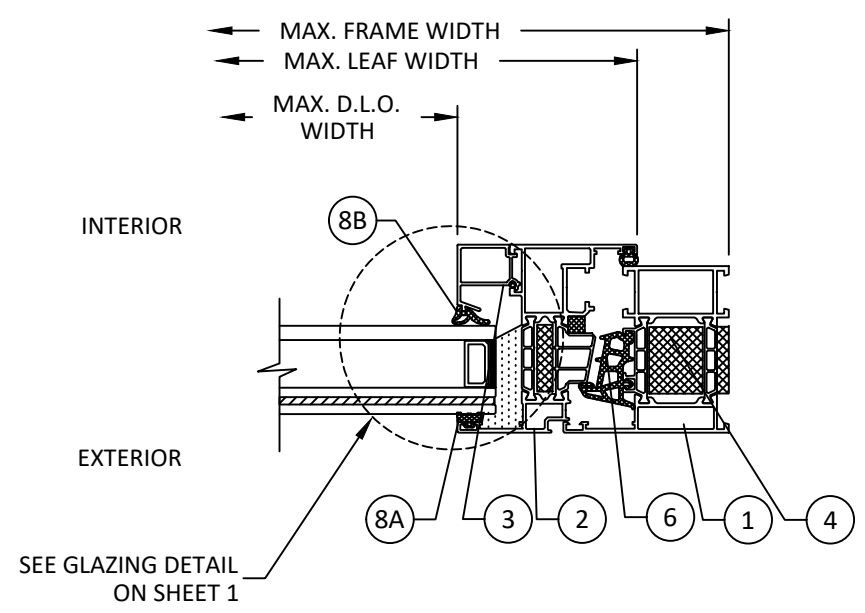

**B**  
5  
HORIZONTAL SECTION  
TYP. JAMB DETAIL



LEBORSKA 31, 77-100  
 BYTOW, POLAND  
 PH: +48-59-822-9101 FX: +48-59-822-9103

TITLE: MB-79N SI  
 BALCONY DOOR WINDOW  
 (HVHZ) (IMPACT)

HORIZONTAL SECTIONS

PREPARED BY:  
**BUILDING DROPS, INC.**  
 1900 NE MIAMI COURT, STE. 2-15  
 MIAMI, FL 33132  
 PH: (954) 399-8478  
 FAX: (954) 744-4738  
 WEB: www.buildingdrops.com



REMARKS	BY	DATE

THE INSTALLATION DETAILS DESCRIBED HEREIN ARE GENERIC AND MAY NOT REFLECT ACTUAL CONDITIONS FOR A SPECIFIC SITE. IF SITE CONDITIONS CAUSE INSTALLATION TO DEVIATE FROM THE REQUIREMENTS DETAILED HEREIN, A LICENSED ENGINEER OR ARCHITECT SHALL PREPARE SITE SPECIFIC DOCUMENTS FOR USE WITH THIS DOCUMENT.

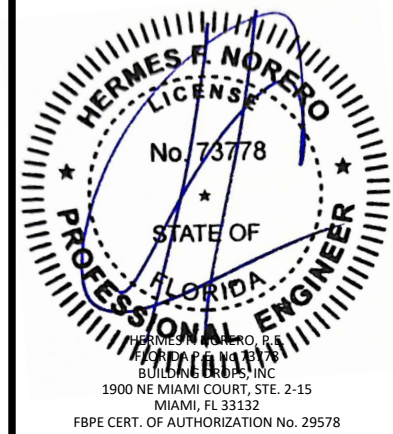

FL #: **FL46724**

DATE: **03.19.24**

DWG. BY: **FB**      CHK. BY: **HFN**

SCALE: **NTS**

DWG. #: **DRU039**

SHEET:  
**5**  
 OF 7



5/1/2024 3:10 PM  
 c:\users\franciscobreno\building\_drops, inc\building\_drops, inc\projects\drutex, s.a\fb-23-0705.1 - fb-submittal - mb79n.si.mbb8n.si.aluminum\_systems\dwg\mb79n.mb79n - balcony\_door\archive\dr0039.dwg



LEBORSKA 31, 77-100  
 BYTOW, POLAND  
 PH: +48-59-822-9101 FX: +48-59-822-9103

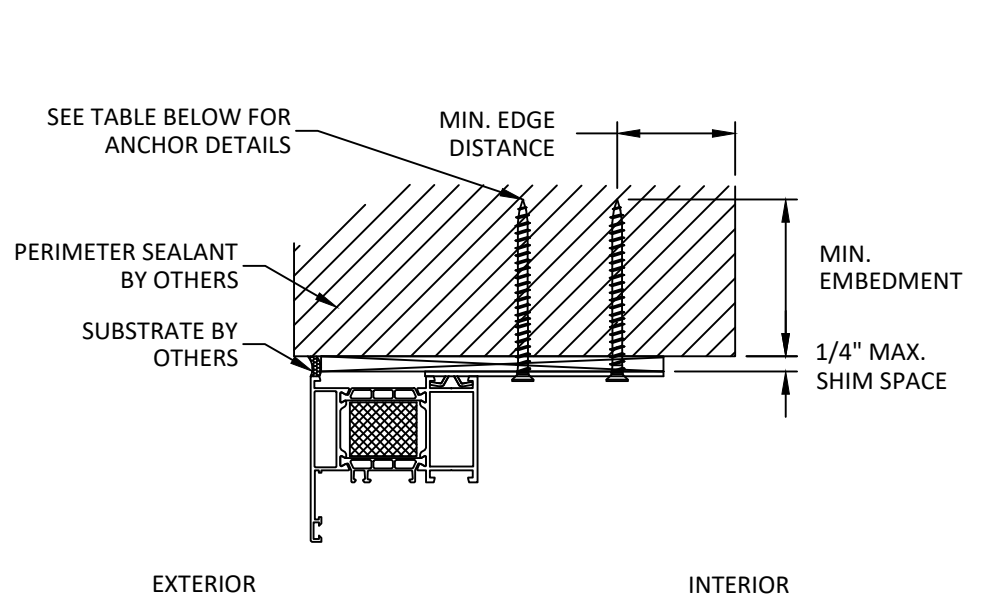

**A**  
**6** VERTICAL SECTION THROUGH STRAP INSTALLATION

NOTE : SILL & JAMB SIMILAR

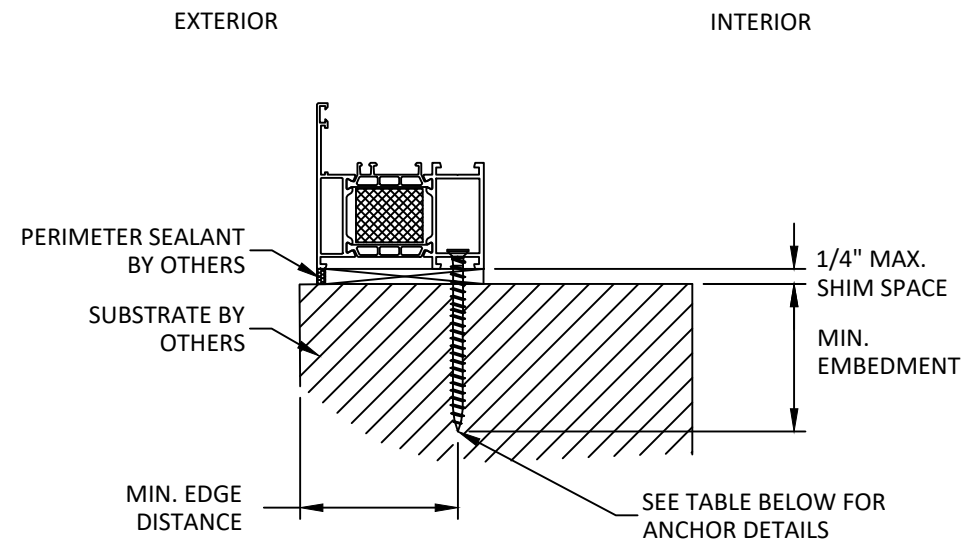

**B**  
**6** VERTICAL SECTION THROUGH FRAME INSTALLATION

NOTE : HEAD & JAMB SIMILAR

**INSTALLATION NOTES:**

- ONE (1) INSTALLATION ANCHOR IS REQUIRED AT EACH ANCHOR LOCATION SHOWN, UNLESS OTHERWISE STATED ON SHEET 3.
- INSTALL INDIVIDUAL INSTALLATION ANCHORS WITHIN A TOLERANCE OF ±1/2 INCH THE DEPICTED LOCATION & SPACING IN THE ANCHOR LAYOUT DETAILS (I.E., WITHOUT CONSIDERATION OF TOLERANCES). TOLERANCES ARE NOT CUMULATIVE FROM ONE INSTALLATION ANCHOR TO THE NEXT.
- SHIM AS REQUIRED AT EACH INSTALLATION ANCHOR WITH LOAD BEARING SHIM(S). MAXIMUM ALLOWABLE SHIM STACK TO BE 1/4 INCH. SHIM WHERE SPACE OF 1/16 INCH OR GREATER OCCURS. SHIM(S) SHALL BE CONSTRUCTED OF HIGH DENSITY PLASTIC OR BETTER.
- MINIMUM EMBEDMENT AND EDGE DISTANCE EXCLUDE WALL FINISHES, INCLUDING BUT NOT LIMITED TO STUCCO, FOAM, BRICK VENEER, AND SIDING.
- INSTALLATION ANCHORS AND ASSOCIATED HARDWARE MUST BE MADE OF CORROSION RESISTANT MATERIAL OR HAVE A CORROSION RESISTANT COATING.
- FOR MASONRY OR CONCRETE OPENINGS, A 1X WOOD BUCK MAY BE USED (OPTIONAL) AS LONG AS THE MINIMUM EMBEDMENT AND EDGE DISTANCE REQUIREMENTS ARE STILL MET WITHIN THE CORRESPONDING HOST SUBSTRATE. SEE GENERAL NOTE #3 ON SHEET 1 FOR MORE INFORMATION.
- FOR HOLLOW BLOCK AND GROUT FILLED BLOCK, DO NOT INSTALL INSTALLATION ANCHORS INTO MORTAR JOINTS. EDGE DISTANCE IS MEASURED FROM FREE EDGE OF BLOCK OR EDGE OF MORTAR JOINT INTO FACE SHELL OF BLOCK.
- INSTALLATION ANCHORS SHALL BE INSTALLED IN ACCORDANCE WITH ANCHOR MANUFACTURER'S INSTALLATION INSTRUCTIONS, AND ANCHORS SHALL NOT BE USED IN SUBSTRATES WITH STRENGTHS LESS THAN THE MINIMUM STRENGTH SPECIFIED BY THE ANCHOR MANUFACTURER.

ANCHOR SCHEDULE				
METHOD	SUBSTRATE	ANCHOR TYPE	MIN. EMBEDMENT	MIN. EDGE DISTANCE
STRAP	WOOD: MIN. SG = 0.55	#8 WOOD SCREW	1.50"	0.75"
	METAL : 18 GA. STEEL MIN. Fy = 33 KSI ALUMINUM 1/8" MIN., 6063-T5	#8 SELF-DRILLING SCREW	3 THREADS MIN. PENETRATION BEYOND STRUCTURE	0.50"
	CONCRETE: f'c = 3000 PSI	3/16" ITW TAPCON	1.25"	2.00"
	MASONRY: CMU per ASTM C90 MIN. 2000 PSI	3/16" ITW TAPCON	1.00"	2.00"
THROUGH FRAME	WOOD: MIN. SG = 0.55	#12 WOOD SCREW	1.50"	0.75"
	METAL : 18 GA. STEEL MIN. Fy = 33 KSI ALUMINUM 1/8" MIN., 6063-T5	#12 SELF-DRILLING SCREW	3 THREADS MIN. PENETRATION BEYOND STRUCTURE	0.50"
	CONCRETE: f'c = 3000 PSI	3/16" ITW TAPCON	1.25"	2.00"
	MASONRY: CMU per ASTM C90 MIN. 2000 PSI	3/16" ITW TAPCON	1.00"	2.00"

TITLE: MB-79N SI BALCONY DOOR WINDOW (HVHZ) (IMPACT)

ANCHOR DETAILS

PREPARED BY: BUILDING DROPS, INC.  
 1900 NE MIAMI COURT, STE. 2-15  
 MIAMI, FL 33132  
 PH: (954)399-8478  
 FAX: (954)744-4738  
 WEB: www.buildingdrops.com

REMARKS	BY	DATE

THE INSTALLATION DETAILS DESCRIBED HEREIN ARE GENERIC AND MAY NOT REFLECT ACTUAL CONDITIONS FOR A SPECIFIC SITE. IF SITE CONDITIONS CAUSE INSTALLATION TO DEVIATE FROM THE REQUIREMENTS DETAILED HEREIN, A LICENSED ENGINEER OR ARCHITECT SHALL PREPARE SITE SPECIFIC DOCUMENTS FOR USE WITH THIS DOCUMENT.

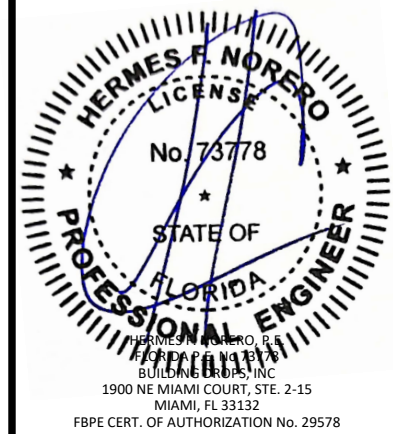

FL #: **FL46724**

DATE: **03.19.24**

DWG. BY: **FB**      CHK. BY: **HFN**

SCALE: **NTS**

DWG. #: **DRU039**

SHEET: **6** OF 7

c:\users\franciscobreno\building\_drops, inc\building\_drops\_landing - common\projects\drutex, s.a\bc-23-0705.1 - bc\_submittal - mb79n.si.mbb8n.si.aluminum\_systems\dwg\mb79n.mb79n - balcony\_door\archive\dr039.dwg 5/1/2024 3:10 PM

BILL OF MATERIALS			
ITEM	PART NO.	DESCRIPTION	MATERIAL
1	K520012	FRAME	6063-T5
2	K520112	LEAF	6063-T5
3	K431624	GLAZING BEAD	6063-T5
4	-	THERMAL MATERIAL	POLYETHYLENE
5	-	GASKET	EPDM
6	8G000020	CENTRAL GASKET	EPDM
7	-	MID-RAIL	6063-T5
8A	120518	GASKET	EPDM
8B	120540	GASKET	EPDM
9	803011040	STRAP	STEEL

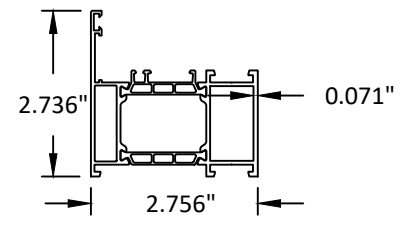

1 FRAME  
6063-T5

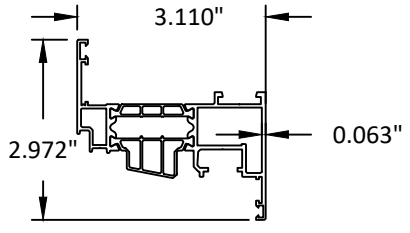

2 LEAF  
6063-T5

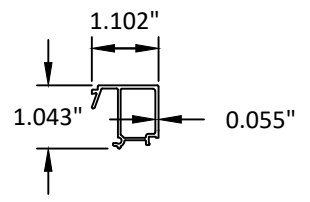

3 GLAZING BEAD  
6063-T5

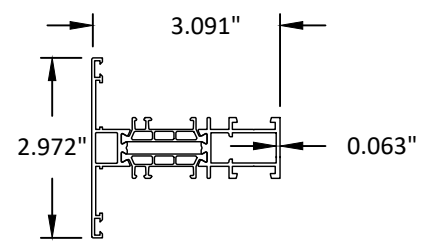

7 MID-RAIL  
6063-T5

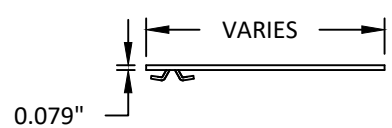

9 STRAP  
STEEL A36



LEBORSKA 31, 77-100  
BYTOW, POLAND  
PH: +48-59-822-9101 FX: +48-59-822-9103

TITLE: MB-79N SI  
BALCONY DOOR WINDOW  
(HVHZ) (IMPACT)

COMPONENTS & BILL OF MATERIALS

PREPARED BY:  
**BUILDING DROPS, INC.**  
1900 NE MIAMI COURT, STE. 2-15  
MIAMI, FL 33132  
PH: (954) 399-8478  
FAX: (954) 744-4738  
WEB: www.buildingdrops.com



REMARKS	BY	DATE

THE INSTALLATION DETAILS DESCRIBED HEREIN ARE GENERIC AND MAY NOT REFLECT ACTUAL CONDITIONS FOR A SPECIFIC SITE. IF SITE CONDITIONS CAUSE INSTALLATION TO DEVIATE FROM THE REQUIREMENTS DETAILED HEREIN, A LICENSED ENGINEER OR ARCHITECT SHALL PREPARE SITE SPECIFIC DOCUMENTS FOR USE WITH THIS DOCUMENT.

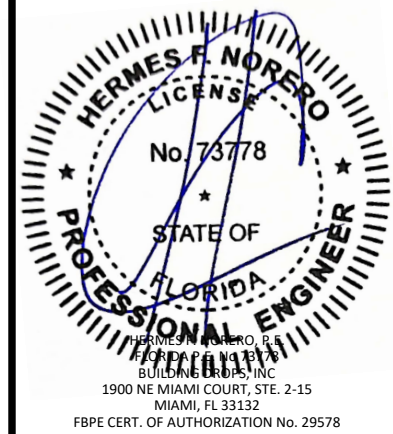

HERMES F. NORERO, R.  
1900 NE MIAMI COURT, STE. 2-15  
MIAMI, FL 33132  
FBPE CERT. OF AUTHORIZATION No. 29578

FL #: **FL46724**

DATE: **03.19.24**

DWG. BY: **FB**      CHK. BY: **HFN**

SCALE: **NTS**

DWG. #: **DRU039**

SHEET:  
**7**  
OF 7